

As suppliers of building and civil engineering products Parchem Construction Supplies Pty Ltd do not offer a design service. Information in this drawing is a suggestion only and must not be used for construction except as a signed off drawing by the specifier or contractor

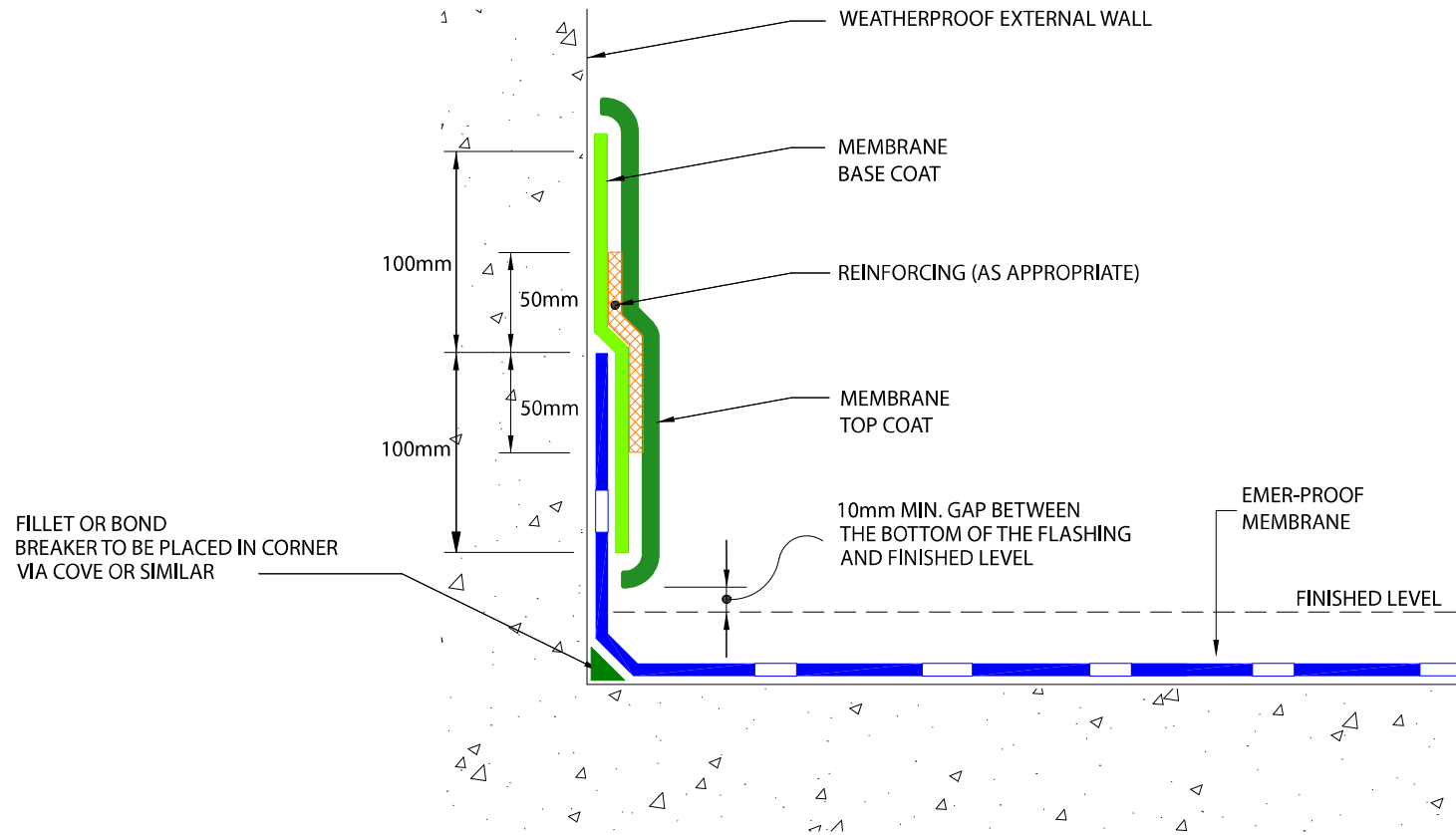

(b) OVERFLASHING CONSTRUCTED OF A LIQUID-APPLIED MEMBRANE

VERTICAL UPWARD TERMINATION - DETAIL OF OVERFLASHING (d)  
(OVERFLASHING CONSTRUCTED OF A LIQUID-APPLIED MEMBRANE)

SCALE:- NTS

DRAWN BY:- EC

DATE:- 8/7/10

LATEST AMENDMENT:- PJ

DATE:- 12/08/19

ISSUE NUMBER 3



PARCHEM CONSTRUCTION SUPPLIES  
7 LUCCA ROAD, WYONG  
NSW 2259  
www.emer.com.au  
1300 283 668