

As suppliers of building and civil engineering products Parchem Construction Supplies Pty Ltd do not offer a design service. Information in this drawing is a suggestion only and must not be used for construction except as a signed off drawing by the specifier or contractor

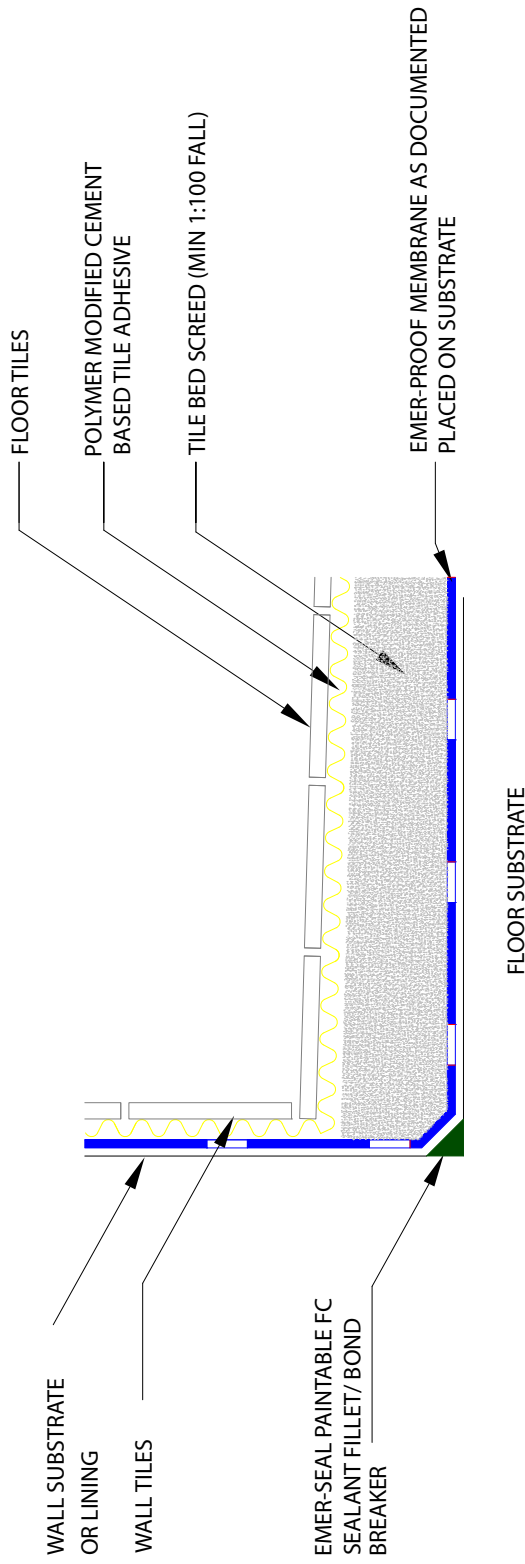

NOTE: WATERPROOF MEMBRANES SHOULD BE TERMINATED AT A MINIMUM HEIGHT OF 150mm ABOVE FINISHED FLOOR LEVEL (EXCEPT IN SHOWER AREAS). WATERPROOF ENTIRE FLOOR AREA.

**TYPICAL UNDER-TILE WATERPROOFING/TILE ADHESIVE SYSTEM  
(MEMBRANE UNDER SCREED) - MEETS AS3740**

SCALE:- NTS

LATEST AMENDMENT:- PJ  
DATE:- 12/07/2021

ISSUE NUMBER 2



Parchem Construction Supplies  
1956 Dandenong Road,  
Clayton VIC 3168  
Phone: 1300 283 668  
ABN 80 069 961 968  
www.Emer.com.au